

## Type DC-R2 Hydraulic Drum Rotator

The type DC-R2 Hydraulic Drum Rotator is designed to lift and rotate 205 litre Drums. A Chain Belly Strap with an eccentric lock holds the Drum firmly in position. Rotation is provided by the Forklift hydraulics and controlled by the 3<sup>rd</sup> function lever.

This unit is designed with a heavy lift capacity. The standard finish is painted enamel.

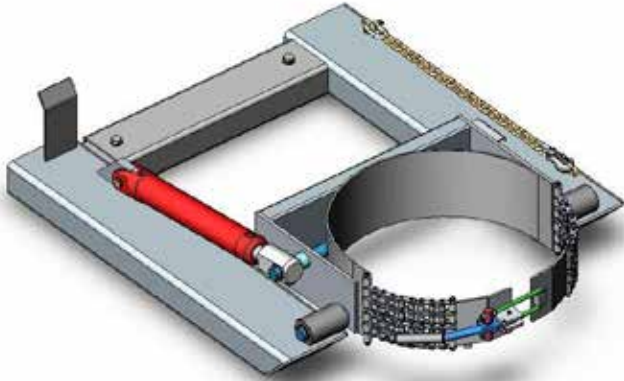

### SPECIFICATIONS:

- Safe Working Load (SWL) 1000kg
- Unit Weight 135kg
- 130° Rotation
- Load Centre 1050mm
- Pocket Size 185 x 65
- Pocket Centres 874mm
- Horizontal C of G 600mm

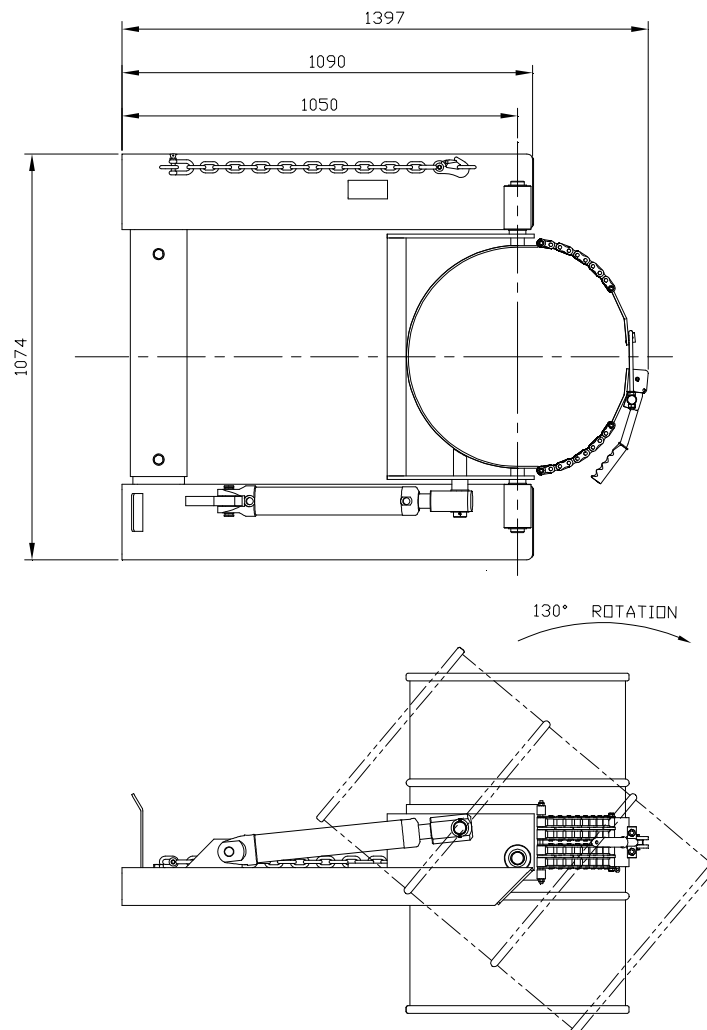

## Type DCR2-PBO Hydraulic Drum Rotator

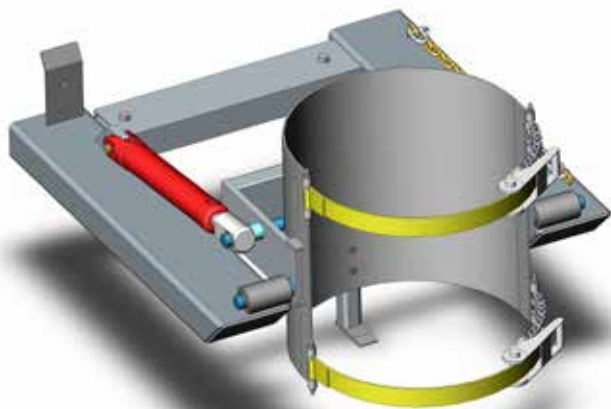

The type DCR2-PBO Hydraulic Drum Rotator is designed to lift and rotate Drums with varying diameters including standard Plastic Drums as well as barrels using dual woven/chain combination Belly Straps with ratchet tightening for clamping. Rotation is provided by the Forklift hydraulics and controlled by the 3<sup>rd</sup> function lever.

The standard finish is painted enamel.

### SPECIFICATIONS:

- Safe Working Load (SWL) 350kg
- Unit Weight 160kg
- 130° Rotation
- Load Centre 1050mm
- Pocket Size 185 x 65
- Pocket Centres 874mm
- Horizontal C of G 630mm

